

Solder Mount EMI Filters

Discoidal Capacitors with Leads

SFSS

Dimensions mm (inches)

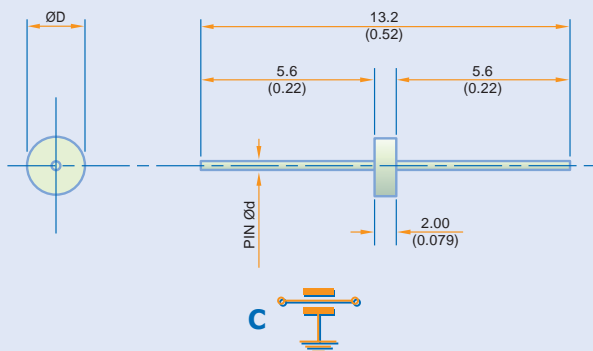

Note: Lead lengths are typical

Electrical details

Electrical Configuration
Capacitance Measurement
Current Rating
Temperature Rating
Dielectric Withstand Voltage

C Filters
 At 1000hr point
 10A for 0.7mm pin, 15A for 1.0mm pin.
 -55°C to 125°C

Rated Voltage	D.W.V.
50 Vdc	125 Vdc
100 Vdc	250 Vdc
200 Vdc	500 Vdc
300 Vdc	600 Vdc
500 Vdc	750 Vdc
1000 Vdc	1250 Vdc
2000 Vdc	2500 Vdc
3000 Vdc	3750 Vdc

Mechanical details

Temperature Rise
Soldering Time
Max Soldering Temp
Solder Type
Capacitor Material
Pin Material

Less than 4°C per second
 10 seconds maximum
 220°C
 SN62 or equivalent
 COG or X7R
 Copper Alloy (Silver plated)

Coloured areas indicate capacitance values available. Preferred values are shown as black.

Cap. Diameter (D)	2.3mm (0.091")					2.8mm (0.110")					3mm (0.118")					5mm (0.197")					8.75mm (0.344")						
Pin Diameter (d)	0.7mm (0.028")					0.7mm (0.028")					0.7mm (0.028")					0.7mm (0.028")					1.0mm (0.039")						
Capacitance Tol.	-20%+80%					-20%+80% up to 47pF ±20% 68pF & above					-20%+80% up to 47pF ±20% 68pF & above					±20%					±20%						
Rated Voltage d.c.	50V	100V	200V	500V	50V	100V	200V	300V	500V	50V	100V	200V	300V	500V	50V	100V	200V	300V	500V	50V	100V	200V	300V	500V	1KV	2KV	3KV
Cap value																											
10pF	●	●	●	●	●	●	●	●	●	●	●	●	●	●													
15pF	●	●	●	●	●	●	●	●	●	●	●	●	●	●													
22pF	●	●	●	●	●	●	●	●	●	●	●	●	●	●													
33pF	●	●	●	●	●	●	●	●	●	●	●	●	●	●													
47pF	●	●	●	●	●	●	●	●	●	●	●	●	●	●													
68pF	●	●	●	●	●	●	●	●	●	●	●	●	●	●													
100pF	●	●	●	●	●	●	●	●	●	●	●	●	●	●													
150pF	●	●	●	●	●	●	●	●	●	●	●	●	●	●													
220pF	●	●	●	●	●	●	●	●	●	●	●	●	●	●													
330pF	●	●	●	●	●	●	●	●	●	●	●	●	●	●													
470pF	●	●	●	●	●	●	●	●	●	●	●	●	●	●													
680pF	●	●	●	●	●	●	●	●	●	●	●	●	●	●													
1nF	●	●	●	●	●	●	●	●	●	●	●	●	●	●													
1.5nF	●	●	●	●	●	●	●	●	●	●	●	●	●	●													
2.2nF	●	●	●	●	●	●	●	●	●	●	●	●	●	●													
3.3nF	●	●	●	●	●	●	●	●	●	●	●	●	●	●													
4.7nF	●	●	●	●	●	●	●	●	●	●	●	●	●	●													
6.8nF	●	●	●	●	●	●	●	●	●	●	●	●	●	●													
10nF	●	●	●	●	●	●	●	●	●	●	●	●	●	●													
15nF	●	●	●	●	●	●	●	●	●	●	●	●	●	●													
22nF	●	●	●	●	●	●	●	●	●	●	●	●	●	●													
33nF	●	●	●	●	●	●	●	●	●	●	●	●	●	●													
47nF	●	●	●	●	●	●	●	●	●	●	●	●	●	●													
68nF	●	●	●	●	●	●	●	●	●	●	●	●	●	●													
100nF	●	●	●	●	●	●	●	●	●	●	●	●	●	●													
150nF	●	●	●	●	●	●	●	●	●	●	●	●	●	●													
220nF	●	●	●	●	●	●	●	●	●	●	●	●	●	●													
330nF	●	●	●	●	●	●	●	●	●	●	●	●	●	●													
470nF	●	●	●	●	●	●	●	●	●	●	●	●	●	●													
680nF	●	●	●	●	●	●	●	●	●	●	●	●	●	●													
1µF	●	●	●	●	●	●	●	●	●	●	●	●	●	●													
1.5µF	●	●	●	●	●	●	●	●	●	●	●	●	●	●													
2.2µF	●	●	●	●	●	●	●	●	●	●	●	●	●	●													

Notes: 1. The above information is a general guide to the range of Discoidal Capacitors with Leads available from Syfer Technology.
 2. For any variations (i.e. pin length or disc position) and detailed part numbers please consult our Sales Office.

notes

1. For detailed part numbers please consult Sales Office.
2. For Insertion Loss information see page 84.
3. For soldering and installation information see page 75.

Solder Mount EMI Filters

2.8mm Body Diameter, Epoxy Sealed

SFSR

Type No.	Capacitance (Z= -20%+80%)	Dielectric Code	Rated Voltage (Vd.c.)	DWV (Vd.c.)
SFSRC5000100ZC0	10pF	C0G	500	750
SFSRC5000220ZC0	22pF	C0G	500	750
SFSRC5000470ZC0	47pF	C0G	500	750
SFSRC2000101ZC0	100pF	C0G	200	500
SFSRC1000221ZC0	220pF	C0G	100	250
SFSRC5000471ZX0	470pF	X7R	500	750
SFSRC5000102ZX0	1nF	X7R	500	750
SFSRC5000222ZX0	2.2nF	X7R	500	750
SFSRC2000472ZX0	4.7nF	X7R	200	500
SFSRC0500103ZX0	10nF	X7R	50	125

Dimensions mm (inches)

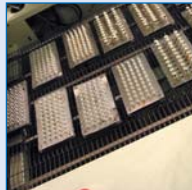
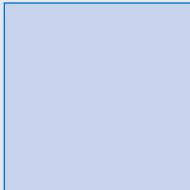
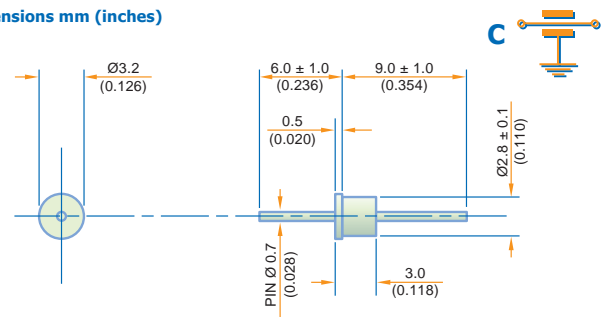

Electrical details

Electrical Configuration	C Filters
Capacitance Measurement	At 1000hr point
Current Rating	10A
Temperature Rating	-55°C to 125°C

Mechanical details

Mounting Hole Diameter	2.9mm (0.114")
Max Soldering Temperature	250°C
Temperature Rise	Less than 4°C per second
Soldering Time	10 seconds maximum
Solder Type	SN62 or equivalent
Weight	0.4g typical (0.015oz)
Finish	Silver plate on copper undercoat

3.25mm Body Diameter, Epoxy Sealed

SFST

Type No.	Capacitance (Z= -20%+80%) (M= +/-20%)	Dielectric Code	Rated Voltage (Vd.c.)	DWV (Vd.c.)
SFSTC5000100ZC0	10pF	C0G	500	750
SFSTC5000150ZC0	15pF	C0G	500	750
SFSTC5000220ZC0	22pF	C0G	500	750
SFSTC5000330ZC0	33pF	C0G	500	750
SFSTC5000470ZC0	47pF	C0G	500	750
SFSTC5000680MC0	68pF	C0G	500	750
SFSTC5000101MC0	100pF	C0G	500	750
SFSTC5000151MC0	150pF	C0G	500	750
SFSTC5000221MX0	220pF	X7R	500	750
SFSTC5000331MX0	330pF	X7R	500	750
SFSTC5000471MX0	470pF	X7R	500	750
SFSTC5000681MX0	680pF	X7R	500	750
SFSTC5000102MX0	1nF	X7R	500	750
SFSTC5000152MX0	1.5nF	X7R	500	750
SFSTC5000222MX0	2.2nF	X7R	500	750
SFSTC5000332MX0	3.3nF	X7R	500	750
SFSTC5000472MX0	4.7nF	X7R	500	750
SFSTC3000682MX0	6.8nF	X7R	300	600
SFSTC2000103MX0	10nF	X7R	200	500
SFSTC1000153MX0	15nF	X7R	100	250
SFSTC0500223MX0	22nF	X7R	50	125
SFSTC0500333MX0	33nF	X7R	50	125

Dimensions mm (inches)

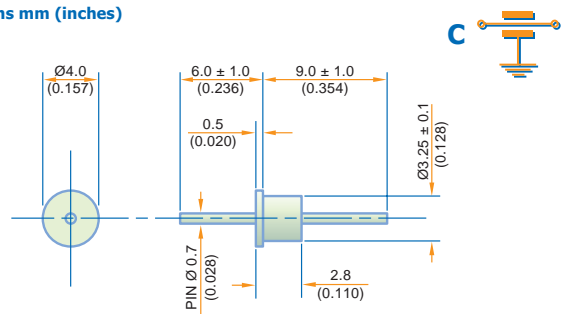

Electrical details

Electrical Configuration	C Filters
Capacitance Measurement	At 1000hr point
Current Rating	10A
Temperature Rating	-55°C to 125°C

Mechanical details

Mounting Hole Diameter	3.5mm (0.138")
Max Soldering Temperature	250°C
Temperature Rise	Less than 4°C per second
Soldering Time	10 seconds maximum
Solder Type	SN62 or equivalent
Weight	0.4g typical (0.015oz)
Finish	Silver plate on copper undercoat

notes

1. For details of ordering see page 85.
2. For Insertion Loss information see page 84.
3. For soldering and installation information see page 75.

Solder Mount EMI Filters

5.6mm Body Diameter, Epoxy Sealed

SFSU

Type No.	Capacitance (Z= -20%+80%) (M= +/-20%)	Dielectric Code	Rated Voltage (Vd.c.)	DWV (Vd.c.)
* SFSUC5000100ZC0	10pF	C0G	500	750
SFSUC5000150ZC0	15pF	C0G	500	750
SFSUC5000220ZC0	22pF	C0G	500	750
SFSUC5000330ZC0	33pF	C0G	500	750
* SFSUC5000470ZC0	47pF	C0G	500	750
* SFSUC5000680MC0	68pF	C0G	500	750
* SFSUC5000101MC0	100pF	C0G	500	750
SFSUC5000151MC0	150pF	C0G	500	750
* SFSUC5000221MX0	220pF	X7R	500	750
* SFSUC5000331MX0	330pF	X7R	500	750
* SFSUC5000471MX0	470pF	X7R	500	750
SFSUC5000681MX0	680pF	X7R	500	750
* SFSUC5000102MX0	1nF	X7R	500	750
SFSUC5000152MX0	1.5nF	X7R	500	750
* SFSUC5000222MX0	2.2nF	X7R	500	750
SFSUC5000332MX0	3.3nF	X7R	500	750
* SFSUC5000472MX0	4.7nF	X7R	500	750
SFSUC5000682MX0	6.8nF	X7R	500	750
* SFSUC5000103MX0	10nF	X7R	500	750
SFSUC5000153MX0	15nF	X7R	500	750
* SFSUC5000223MX0	22nF	X7R	500	750
SFSUC5000333MX0	33nF	X7R	500	750
* SFSUC5000473MX0	47nF	X7R	500	750
SFSUC5000683MX0	68nF	X7R	500	750
* SFSUC3000104MX0	100nF	X7R	300	600
SFSUC2000154MX0	150nF	X7R	200	500
* SFSUC1000224MX0	220nF	X7R	100	250
SFSUC0500334MX0	330nF	X7R	50	125
* SFSUC0500474MX0	470nF	X7R	50	125

Dimensions mm (inches)

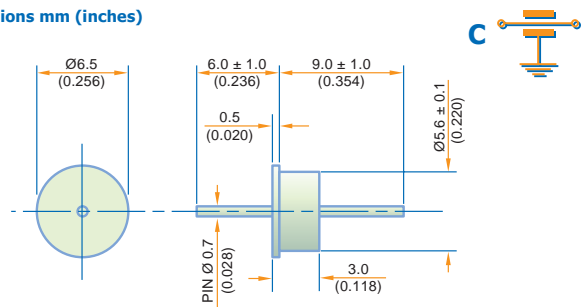

Electrical details

Electrical Configuration C Filters
Capacitance Measurement At 1000hr point
Current Rating 10A
Temperature Rating -55°C to 125°C

Mechanical details

Mounting Hole Diameter 5.8mm (0.228")
Max Soldering Temperature 250°C
Temperature Rise Less than 4°C per second
Soldering Time 10 seconds maximum
Solder Type SN62 or equivalent
Weight 0.7g typical (0.025oz)
Finish Silver plate on copper undercoat

M2.5 Thread

3.5mm Round Head

SFNO

Type No.	Capacitance (Z= -20%+80%)	Dielectric Code	Rated Voltage (Vd.c.)	DWV (Vd.c.)
SFNOC 1000100ZC0	10pF	C0G	100	250
SFNOC 1000220ZC0	22pF	C0G	100	250
SFNOC 1000470ZC0	47pF	C0G	100	250
SFNOC 1000101ZC0	100pF	C0G	100	250
SFNOC 1000221ZC0	220pF	C0G	100	250
SFNOC 1000471ZX0	470pF	X7R	100	250
SFNOC 1000102ZX0	1nF	X7R	100	250
SFNOC 1000222ZX0	2.2nF	X7R	100	250
SFNOC 1000472ZX0	4.7nF	X7R	100	250
SFNOC 0500103ZX0	10nF	X7R	50	125

Dimensions mm (inches)

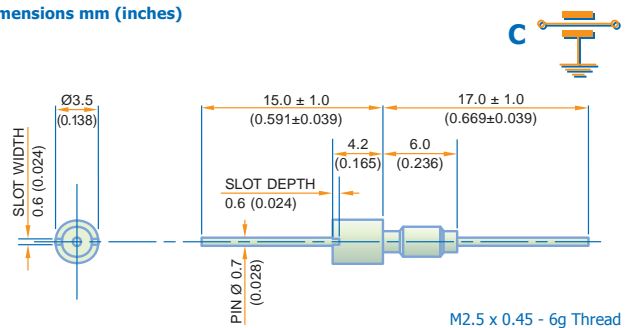

Electrical details

Electrical Configuration C Filters
Capacitance Measurement At 1000hr point
Current Rating 10A
Temperature Rating -55°C to 125°C

Mechanical details

Nut A/F N/A. For use in tapped hole
Head Diameter 3.5mm (0.138")
Washer Diameter N/A
Mounting Torque 0.15 Nm (1.7 lbf in) max.
Mounting Hole Diameter N/A
Max Panel Thickness N/A
Weight 0.6g typical (0.02oz)
Finish Silver plate on copper undercoat

notes

1. For details of ordering see page 85.
2. For Insertion Loss information see page 84.
3. For soldering and installation information see page 75.